



	
SEDE REGIONALE PUGLIA UFFICIO TECNICO - BARRI - VIA PUTIGNANI 108	
CODICE: LAVORI DI MANUTENZIONE STRAORDINARIA PROGETTI ESTERNI EDIFICIO PER UFFICI INPS DI BARRI VIA PUTIGNANI / VIA CAROLI	
TAVOLA A7	ELABORATO: PROGETTO ESECUTIVO PIANTE PIANO QUINTO
DATA: SETT. 2008 SCALE: 1:100	PROGETTISTI: STUDIO REGIONALE PREVIDENZA SOCIALE COLLABORATORE: DR. VINCENZO DEVALO

PIANO QUINTO

H = mt. 3,00

-  balcone A
-  balcone E
-  balcone C
-  balcone F

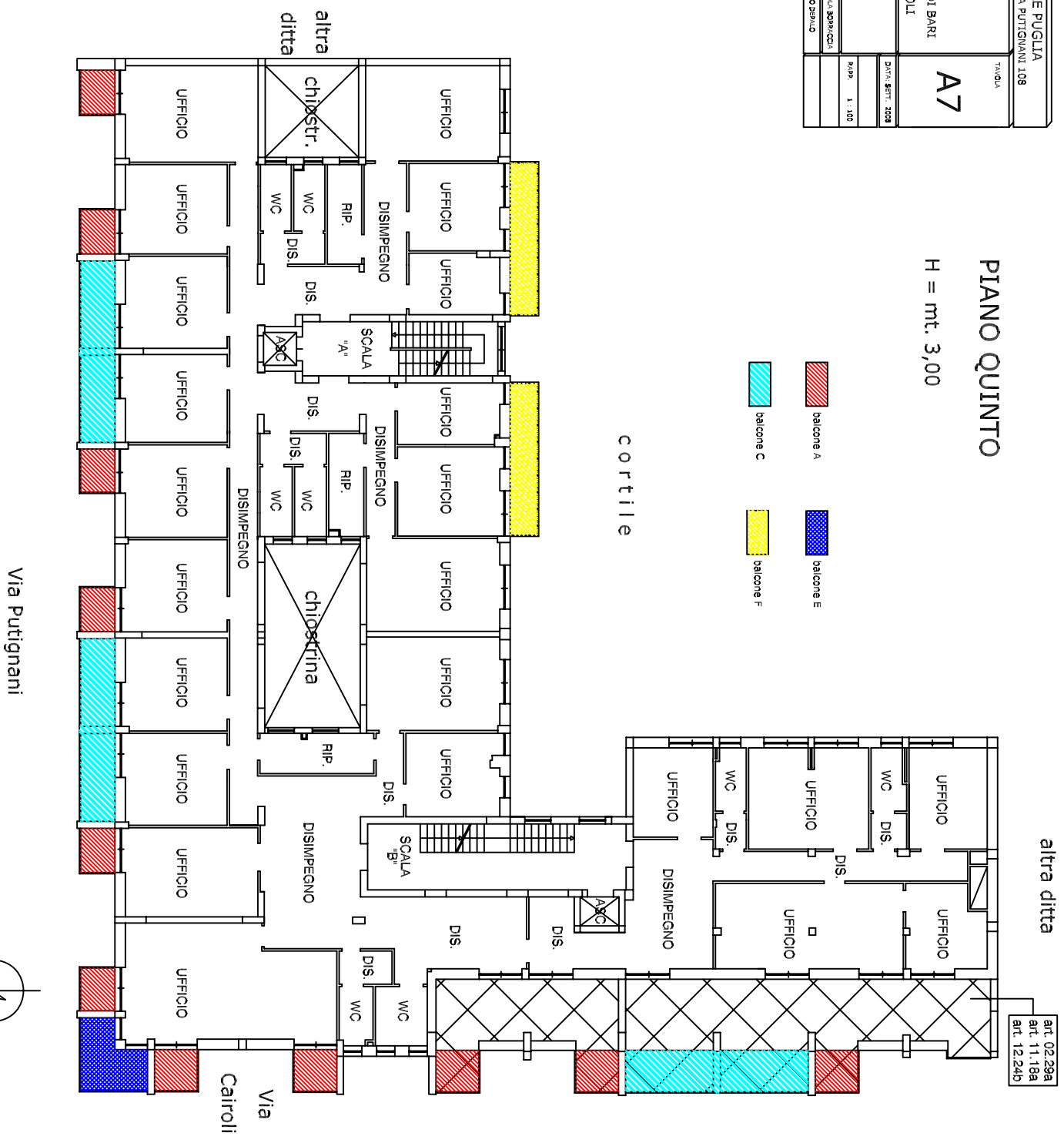

art. 02.29a
 art. 11.16a
 art. 12.24b