







P.ZZA 2 SETTEMBRE 1943

IL PROGETTISTA
(per. ind. Andrea Nardelli)

IL RESPONSABILE DEL PROCEDIMENTO
(arch. Paolo Segala)

LEGENDA

-  Punto doppio cablaggio strutturato (scatola 504)
-  Punto doppio cablaggio strutturato esistente
-  Punto elettrico (1 presa univers. + 2 biprese in scatola 504)
-  Quadro Elettrico
-  Presa CEE interbloccata
-  Canale metalliche 150x75 in pavimento sopraelevato
-  Canale metalliche 200x75 o 300x75 in controsoffitto

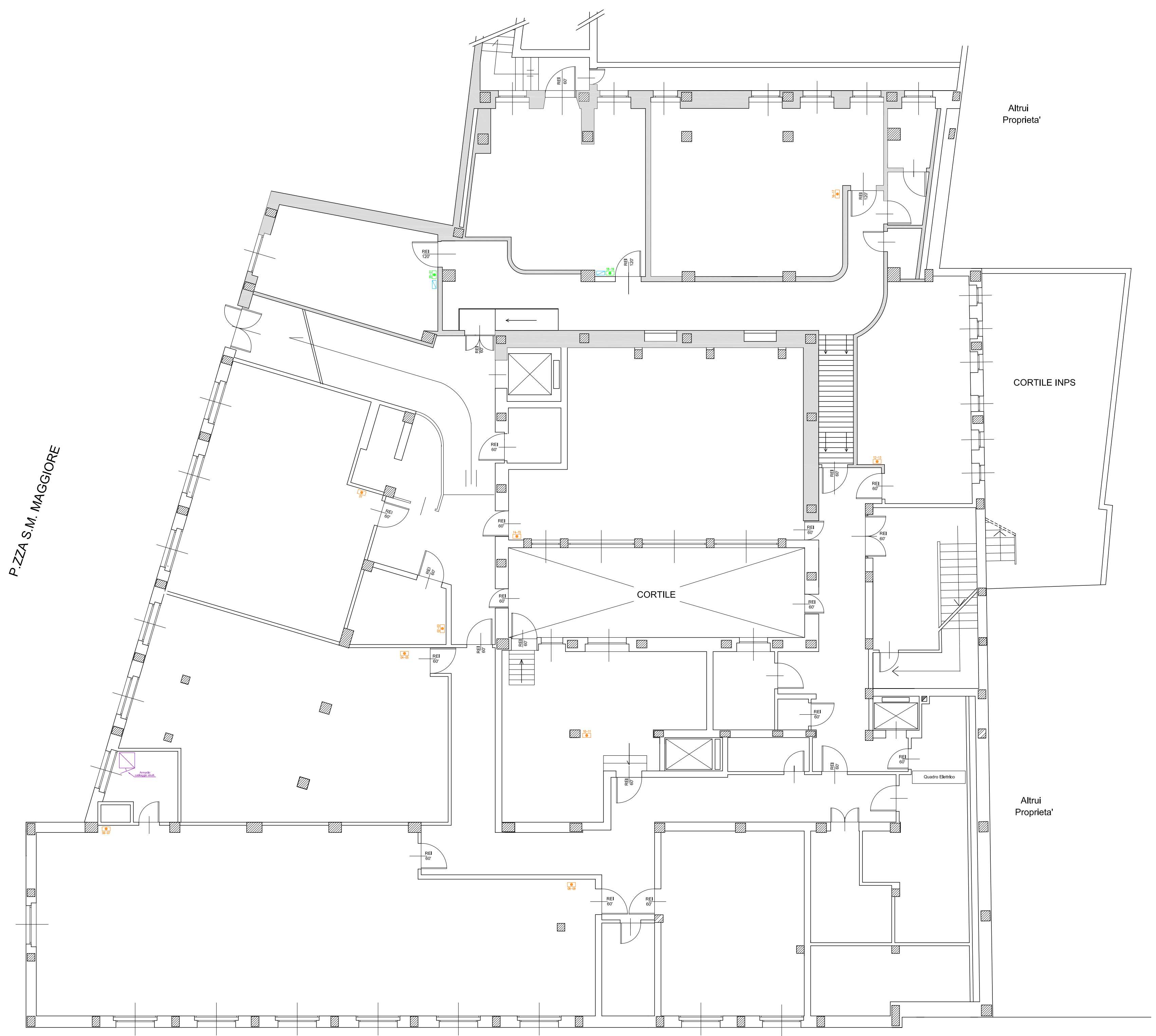

VIA DELLE ORFANE