









DATA : Febbraio 2011	SCALA: 1:100	TAV. n°: 11
SEDE PROVINCIALE TRENTO - VIA DELLE ORFANE, 8 PROGETTO DI SISTEMAZ. AREA EX CED AL 1° PIANO E ARCHIVI AL PIANO INTERRATO		FILE: ---
PIANO INTERRATO - SCHEMA PLANIMETRICO IMPIANTO ANTINCENDIO		AGG.: ---
SCHEMA Impiantistico: per. ind. Andrea Nardelli	CONC.ED.n°	---
PROGETTO architettonico: arch. D. De Giusti - geom. F. Lorenzini	del	---

IL PROGETTISTA
(per. ind. Andrea Nardelli)

IL RESPONSABILE DEL PROCEDIMENTO
(arch. Paolo Segala)

LEGENDA

ANTINCENDIO

-  Centrale Rilevazione Fumi
-  Sirena Allarme Esterna
-  Rivelatore Ottico in Ambiente
-  Rivelatore Ottico/Termico in Ambiente
-  Rivelatore Ottico in pavimento sopraelevato
-  Rivelatore Ottico in controsoffitto
-  Pulsante Allarme Antincendio
-  Pannello Ottico-Acustico
-  Sistema ad aspirazione nel pavimento sopraelevato

P.ZZA 2 SETTEMBRE 1943

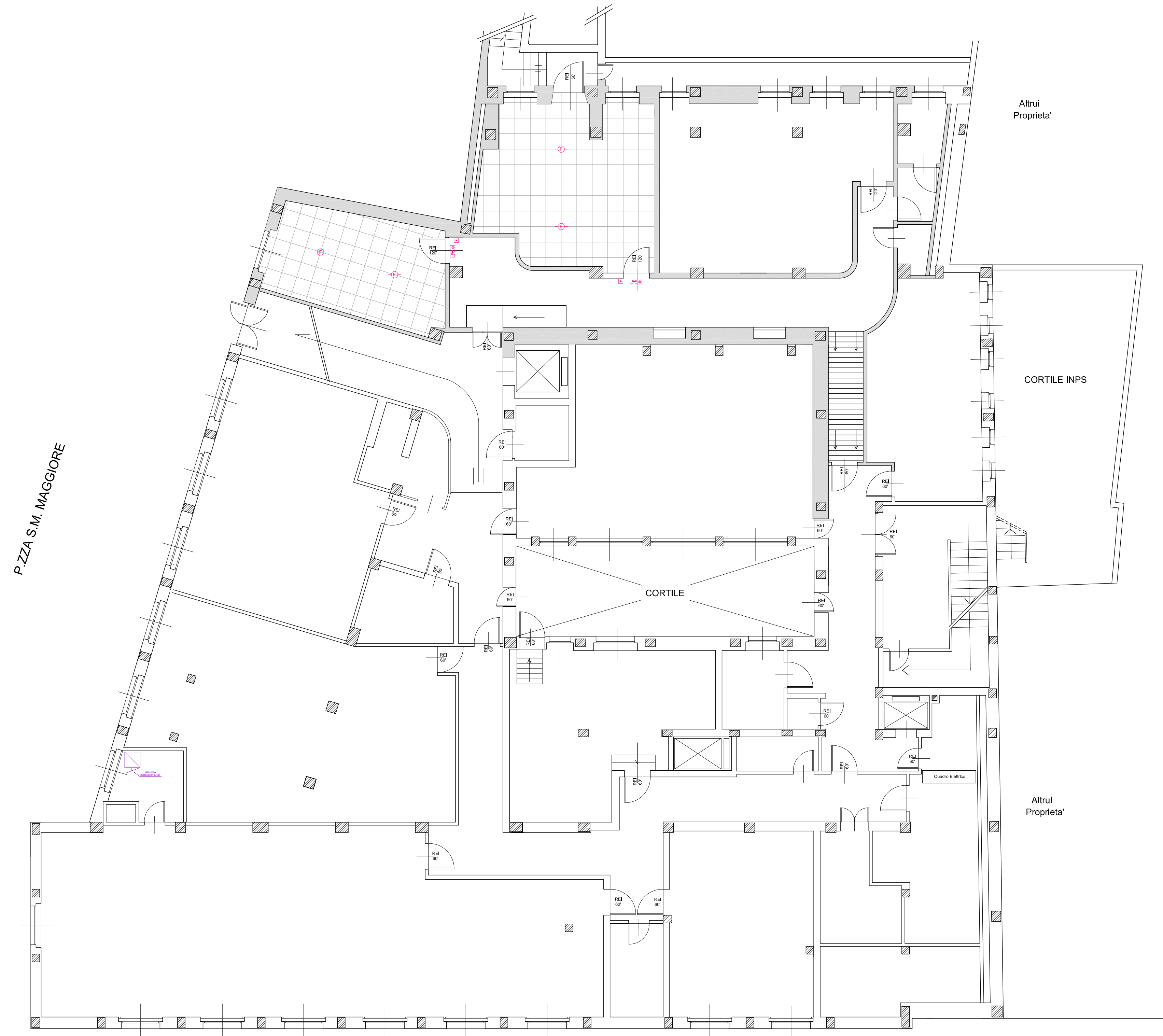

VIA DELLE ORFANE