

VIA MORO

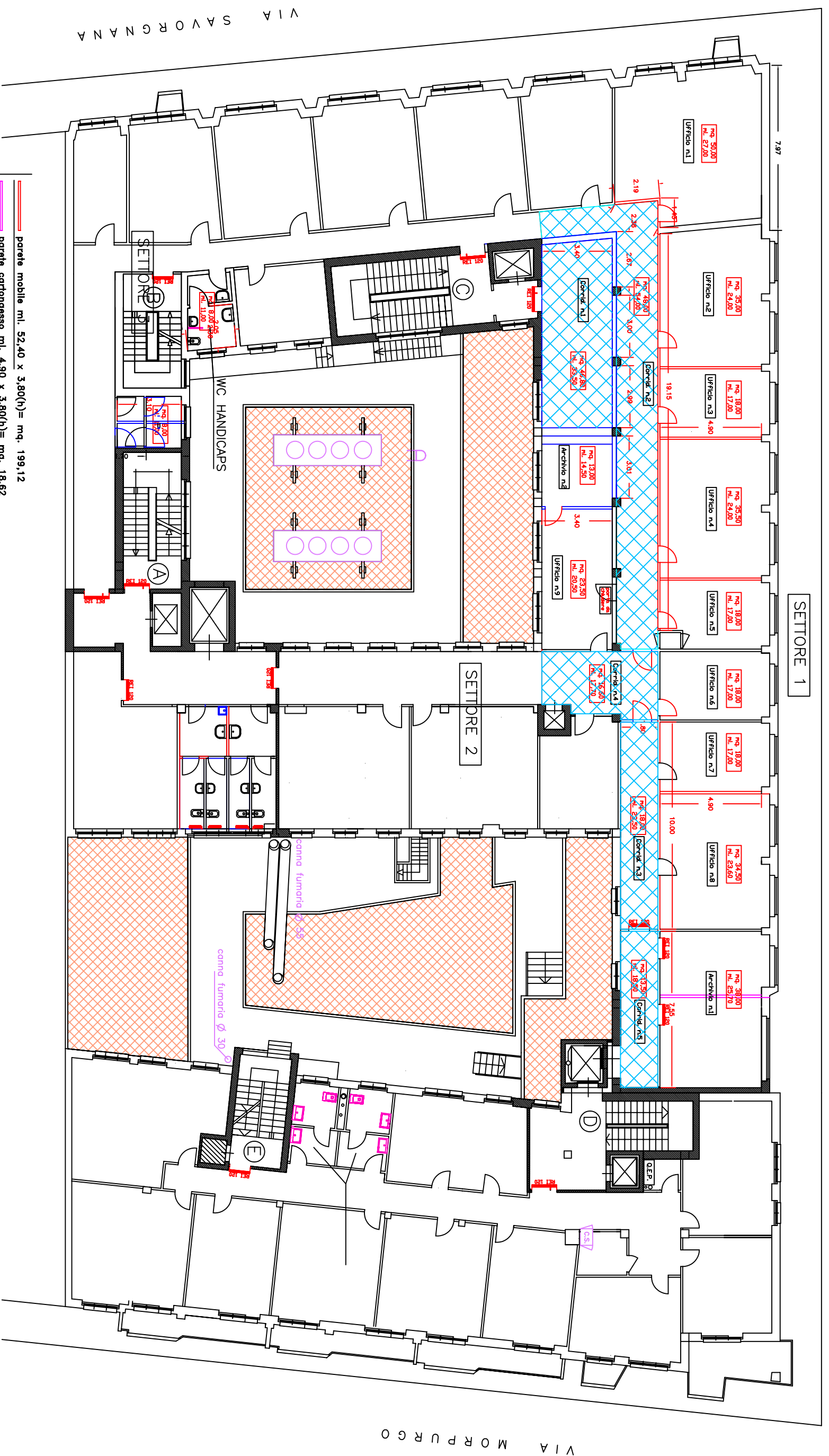

- parete mobile ml. 52,40 x 3,80(h) = mq. 199,12
- parete cartongesso ml. 4,90 x 3,80(h) = mq. 18,62
- parete in muratura ml. 21,80 x 3,80(h) = mq. 82,84
- controsoffitto mq. 143,00

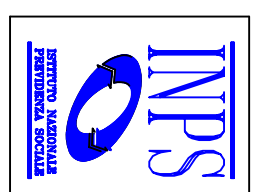
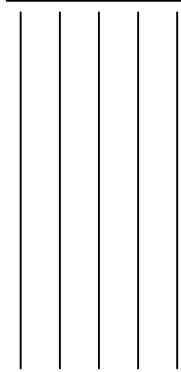

Progettato da	Arch. Bruno Colantonio	TAV. 2
Approvato da		Data
		LUGLIO 2010.
		Scala
SEDE REGIONALE FRIULI-VENEZIA GIULIA Via C. Battisti, 10/D - 34125 TRIESTE	PROGETTO PIANO PRIMO	
AREA PROFESSIONALE TECNICO EDILIZIA	DEMOLIZIONI	